

Kendall
Kingscott

Career Opportunity

Principal Building
Safety Advisor &
Fire Engineer



An amazing opportunity awaits...

Kendall Kingscott is unique.

We strike the perfect balance between large corporates and smaller, individual entities, bringing the positives of both.

We can operate with agility while providing the stability and experience expected of a 60-year established business.

We've spent the past three years carefully crafting our strategic business plan, all while experiencing excellent growth and culminating in the launch of our new brand in 2023. Our blueprint – *The Modern Way* – is about putting social purpose at the core of everything we do, creating an environment where people can thrive, and our business succeeds.

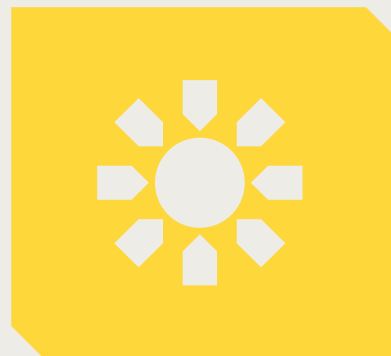

9.2%

**staff turnover,
compared to national
average of 18.2%**

KK is a place where careers flourish. Our statistics speak for themselves: low staff turnover, countless success stories of career progression, impressive training success rates and sustainable repeat business. Our innovative remuneration packages prioritise health and wellbeing. We're seeking dynamic individuals to join us on our ambitious journey.

Making a difference since 1962

Our 60-year journey has been one of organic evolution.

It's guided us to where we are today – **an inter-disciplinary construction consultancy** operating collaboratively with outstanding results.

Our strategy has provided the foundations for the strongest period of growth in the company's history. Yet our new plan is only just beginning.

Our clients like to work with us and our unique, holistic approach.

We curate the perfect team for each project, either as individual disciplines or fully integrated solutions under one umbrella. We call it **1 Team**.

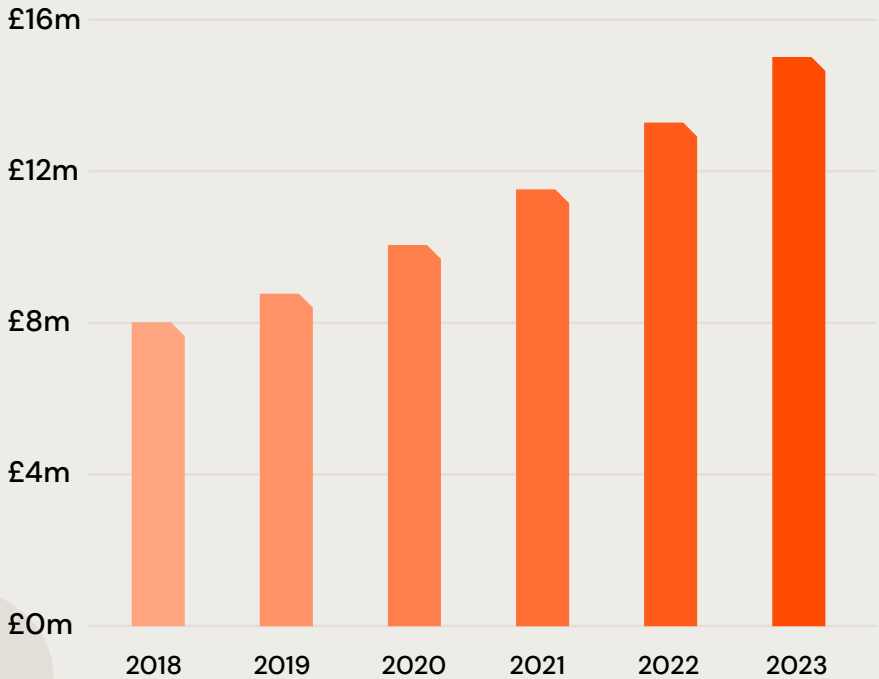

87.5%
growth across all
departments during past
five years

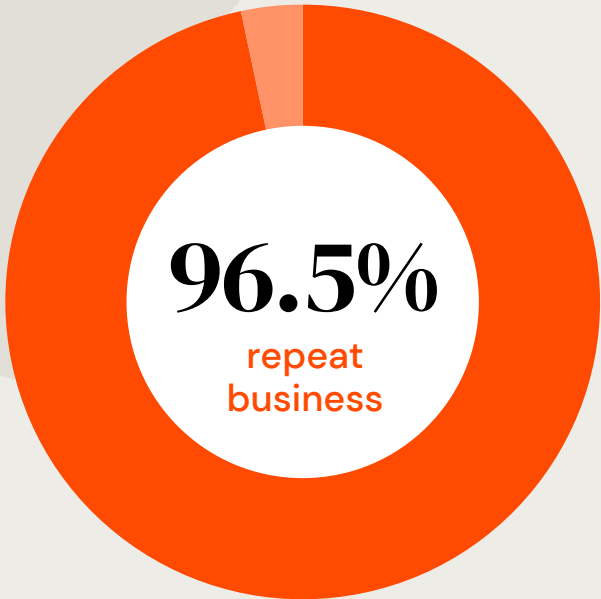

The three principles that guide us



Collaborate



Cultivate

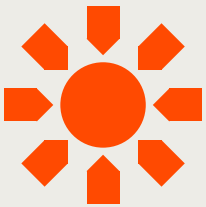

Contribute

Be part of a great team

1Team provides the framework to take our projects to new heights. We go **beyond expectations** within a positive, collaborative team environment.

Experience the difference: an unrivalled service, promoting positive energy with positive outcomes.



Delivering great projects

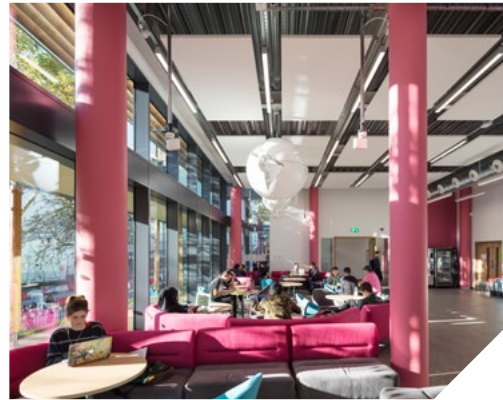

And working with a developing portfolio of clients

20+ years

Logos of clients with 20+ years of partnership:

- Avon & Somerset Constabulary
- the guinness partnership
- NHS North Bristol NHS Trust
- mitie
- Wessex Water YTL GROUP
- Royal Mail
- ALDI
- KIER
- UNIVERSITY OF BATH
- BRISTOL CITY COUNCIL
- Interserve
- University of Bristol
- Nuffield Health
- MARLBOROUGH COLLEGE
- SOAS University of London
- Brunel University London
- University of Reading
- Sanctuary
- NHS Property Services
- Circle Health Group
- DORSET POLICE
- CREST NICHOLSON
- SOMERSET County Council
- BCP Council
- Bellway
- CORNWALL COUNCIL one and all • oen hag oll
- SOVEREIGN
- South Western Ambulance Service NHS Foundation Trust

5-10 years

Logos of clients with 5-10 years of partnership:

- mace
- UNIVERSITY OF PLYMOUTH
- National Oceanography Centre
- Wiltshire Council
- Exeter City Council
- bam
- WILLMOTT DIXON
- CARDIFF UNIVERSITY PRIFYSGOL CAERDYDD
- SCIENCE MUSEUM
- LONDON METROPOLITAN UNIVERSITY
- UNIVERSITY OF WINCHESTER
- NHS Salisbury NHS Foundation Trust
- KING'S College LONDON
- University of Exeter
- NHS University Hospitals Dorset NHS Foundation Trust
- ETON COLLEGE
- Lifeboats
- Dŵr Cymru Welsh Water
- UCL
- Harrods
- SPAR
- SOMERSET POLICE

10-20 years

1-5 years

An environment where people flourish...

As we step into the next decade, we are committing to and building on the visions of those before us. Our goal is to be a **net zero operation by 2028**.

Continuing to empower our staff to flourish and exceed expectations on every level. Dedicated to service, high standards and a positive impact on society and the planet.

Integrity

We work with respect, pride and transparency. We take shared ownership of projects and are proud of what our company name represents.



Nurturing

This is a place for every person at every level. We support each individual regardless of background or ambitions. We're nurturing a safe, open environment that encourages organic development.



Humility

We let our work do the talking. No egos, no prima donnas – just a committed team who relish a challenge and work together for the best results.



Impact-driven

Our work has a direct impact on society, our industry, and the built and natural worlds. Ensuring this impact is positive drives our decision-making.



People-centric

Our success is built on our long-term relationships. We genuinely care about our clients and each other.



Progressive

We're always looking to evolve to be a better version of ourselves.

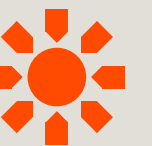

The KK Way ...it's in our DNA

Alongside 1 Team, sits our cultural development & training programme entitled **The KK Way**.

Divided into **eight key themes**, The KK Way provides the framework that underpins our principles, empowering authentic excellence in our staff.



Opportunities for all

This is a place for every person at every level. We support each individual regardless of background or ambitions.

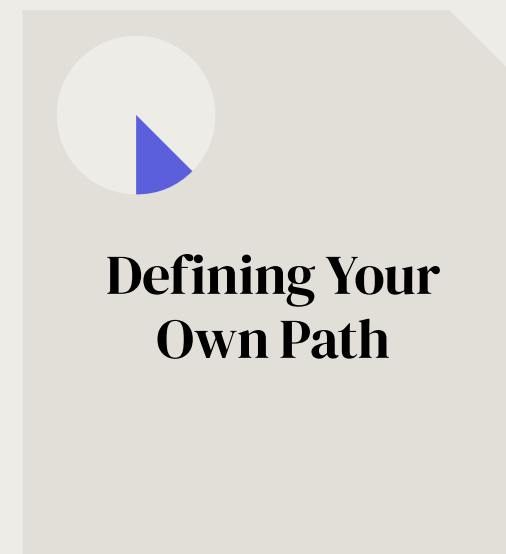
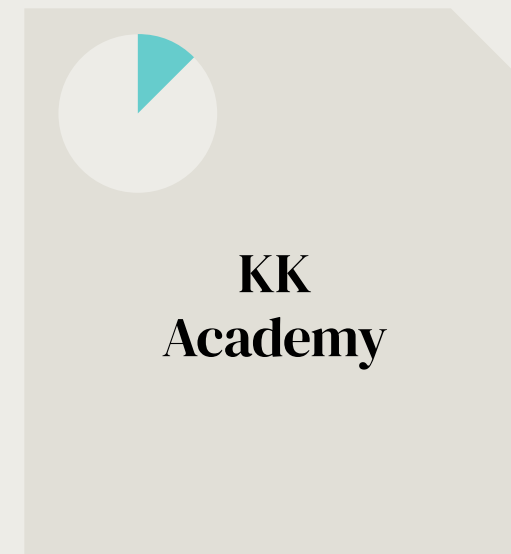

Going beyond

We provide the cultural and technical breeding ground for our people to excel in a purpose-driven environment.

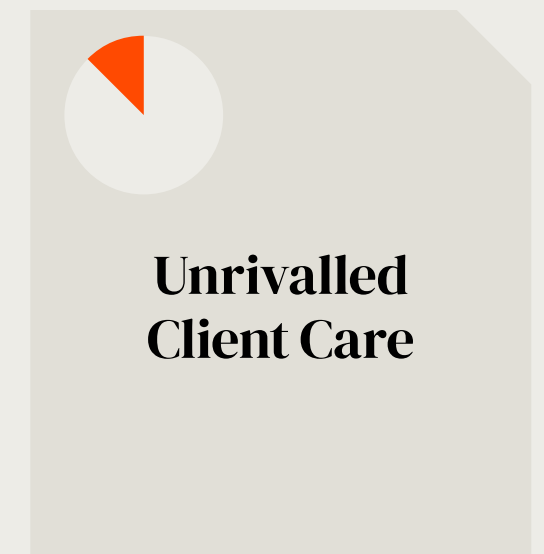
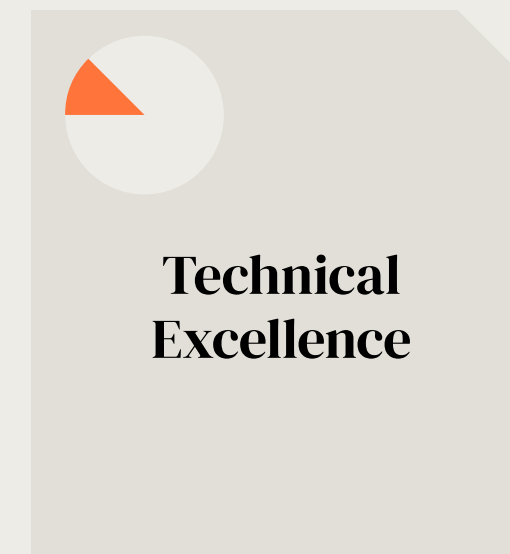

But it's not all work, work, work...



Market leading innovative benefits that support your wellbeing & grow with you

Health and wellness options

Our Health and Wellness benefits programme is driven by our business purpose that gives you access to a host of options that increase with length of service. At every level, our Employee Assistance Programme provides a 24-hour confidential helpline and we also offer discounted gym membership / sports equipment, free eye-tests and regular seminars that cover a range of wellbeing topics, including mental health. Where Private Medical Insurance is offered, it gives the added protection of your immediate family members. After a period, you'll benefit from voluntary health screening, regardless of level.



Insurance against unfortunate events

All staff benefit from a life assurance protection policy at four times annual salary to a nominated beneficiary. We also offer income protection insurance at some levels.



The KK Way

You will never stand still at KK. Staff have the opportunity to study and continue to develop with us. We have highly successful training programmes at all levels including our Academy. For aspiring leaders, we have developed an excellent Leadership & Management Programme that will ease the transition into management roles. We give generous paid study leave benefits, training allowances and professional subscriptions are paid for all staff.



Social workers

At KK we work hard, and play hard too. We hold regular company subsidised social events that could see you enjoying sea or river cruises, taking in air displays, sporting events or just kicking back with a few tipples at our local haunt.

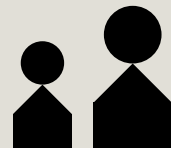

Incentivising sustainable forms of travel that will benefit you

Our business is aspiring to be Net Zero by 2028. That's why we provide the opportunity to lease an electric vehicle via the company's EV Salary Exchange Scheme (subject to qualifying conditions) – offering an affordable and tax efficient way to do your bit for the planet. If a vehicle is not your thing, you can also procure a bicycle for commuting via the company's Cycle to Work Scheme by salary exchange which also has tax efficiencies.



And there's more...

Work, life harmony sits at the heart of our business

We want our people to work to their best ability and recognise the importance of a fruitful life outside of work is key to this. That's why we offer market-leading annual leave options that increase with length of service, innovative training programmes that promote harmony in your work, life experiences, and an agile and hybrid working policy that strikes a balance between our clients, you and the business.



A little thank-you for your commitment to KK

If you, like many others, enjoy working at KK, you will be rewarded with a combination of enhanced benefits over time. Enhanced holiday allowances, increased pension contributions, health and wellbeing benefits, as well as one-off celebratory holiday(s) and vouchers that increase with number of years served.



Grand offers

Some extra cash for your Piggy Bank. We'll give you up to £1,000 bonus if, like yourself, you know someone who might be great addition to the KK Team.



Reward

Our salaries are very competitive, reviewed annually, and include a company wide annual bonus if we've done well. We cover company travel and offer daily subsistence allowances for staff on the move.

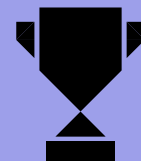

Team working

Whoever your team is, at KK you'll only have 1 Team – a winner every time. Our team approach is central to our ethos and ability to provide an outstanding service to our clients. Never feel alone again!



Giving back

We support a number of charities and hold regular fund raising events across the company. Whether its baking cakes, partaking in our Tour de-Four cycle event, hiking across the Jurassic Coast path, midnight walks, there's always something to look forward to.



The role:

Principal Building Safety Advisor & Fire Engineer

A unique opening to lead KK's Building Safety Advisory services across the practice with the opportunity for career progression in a supportive, inclusive and values-driven environment



Location: National

We are seeking a motivated and ambitious individual from the Building Control Industry to lead our Building Safety Advisory Services under the Building Safety Act.

Working across the practice, you will be supported by a team of existing talented Architects, Building Surveyors, Technologists and M&E Designers that will operate as local Building Safety Advisors supporting our wide array of projects across multiple sectors.

This opportunity could also unlock extended technical service offerings such as Fire Engineering Design.

This is an unmissable opportunity to influence and shape the direction of KK's strategic development of this service offering.

If you are driven and hungry for a new opportunity that will bring the excitement of a start-up (without the risk), apply now!

Job description:

Team role

Our inter-disciplinary 1 Team approach sits at the heart of our delivery model. Following the enactment of the Building Safety Act, we recognise our role as Lead Designers sits central to the Act and must be an integral part of our wider service offering across our business.

This position involves a comprehensive understanding of building safety principles, regulations, and best practices.

The advisor will work closely with construction teams, Architects, Engineers, and Property Managers to ensure that all aspects of building design, construction, and maintenance meet the required safety standards.

We are confident that this lead role will see the recruitment of similarly qualified individuals to provide a defined BSA service offering as the Act and its requirements evolve, so an appetite to manage and grow a team is essential. You will be working in a like-minded, refreshing, supportive team environment for a common purpose.

The role is flexible, and therefore your base could be any one of our four key hubs. However, you will be required to visit other offices from time to time in the course of duty and oversight of projects.

Individual responsibilities

- Working with Directors and Key Leads to ensure our Building Safety Advisory role meets the requirements of the Act, our client's expectations, and its wider strategic objectives on a significant range of long-standing high-profile clients.
- Potential oversight and growth of BSA Team, with the possibility of Fire Engineering Services.
- Overseeing fee submissions, commercial terms and appraising risk in consultation as applicable.
- Initial responsibility for performance of the BSA role on High Risk Buildings (HRBs) which represents a small part of our overall

workload, subject to review of volume of work and ability to service (may require further appointments).

- Support teams to ensure all applicable projects comply with the Building Safety Act and other relevant legislation, regulations, and standards. This includes staying updated with any changes in building safety laws and guidelines.
- Lead training sessions for construction teams and building management on building safety practices and emergency response protocols.
- Providing technical and strategic advice regarding the Act and making recommendations for improvement of our service offering and providing regular support and guidance for Local BSAs.
- Offering suggestions for further diversity of our services and the 1 Team offer – e.g., Fire Engineering, or other bespoke technical / Building Regulations focussed areas.

Skills and requirements

- Bachelor's degree in Construction, Architecture, Engineering, or related with excellent knowledge of current Building Regulations.
- Member of a Professional Institution is desirable.
- Proven track record in a Building Regulations / Control compliance role.
- Fire engineering skills / qualifications advantageous but not essential.
- Experience of Microsoft Suite (MS365).
- Full driving licence is essential.
- Excellent communication and ability to build strong team bonds with staff – including senior executives and clients.
- Formal management training advantageous, though further coaching and support will be given through our Leadership and Management training programme.
- Experience in some or all of our key sections is beneficial – Healthcare, Higher Education, Schools, Retail / Commercial.

So why apply for a career at KK?

1

Inspiring environment with purpose driven business ethos that creates conditions for people to thrive.

2

Market leading benefits that increase with length of service, and promote a healthy work, life blend.

3

Sustainable growth strategy that retains both small-company team agility with the safety net and opportunities of a larger corporate entity.

4

Long-standing, **supportive cultural and formal training models** at the epicentre of our business, The KK Way.

5

Incredible statistics – high staff retention, training success, repeat business and more.

6

It's a great place to work, full of inspiring, supportive, individuals focussed on upholding the KK 1 Team ethos for a common goal, delivering interesting projects for high profile clients.

Ready to apply?

To apply for this exciting opportunity, please contact us with a covering letter and CV at careers@kendallkingscott.co.uk. We look forward to hearing from you!



careers@kendallkingscott.co.uk



www.kendallkingscott.co.uk

Stats we're proud of!

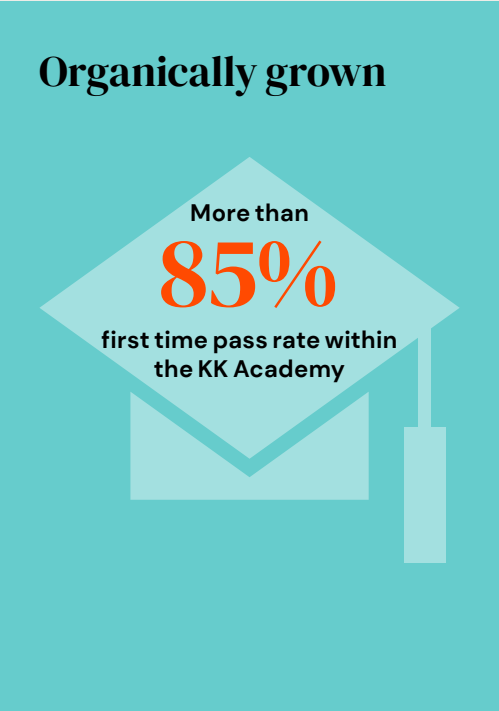
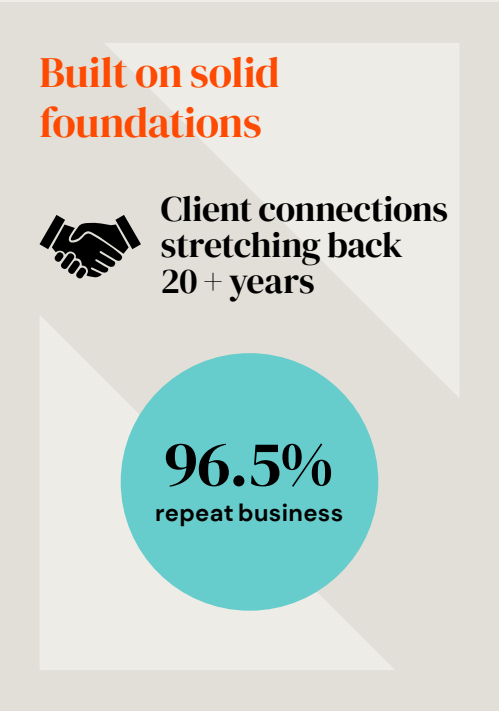
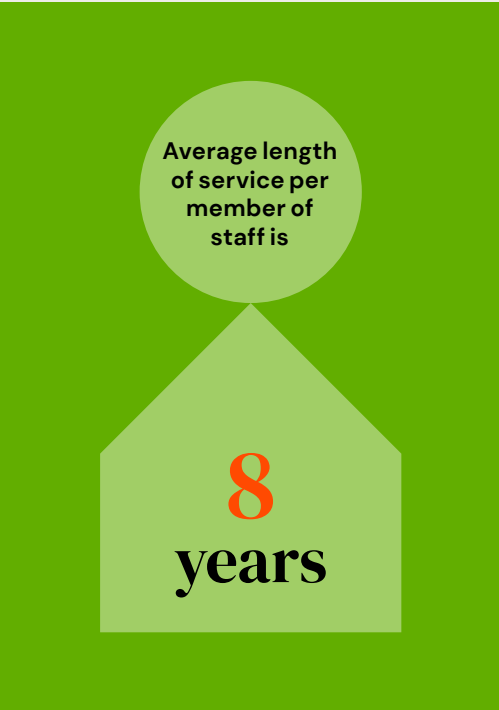
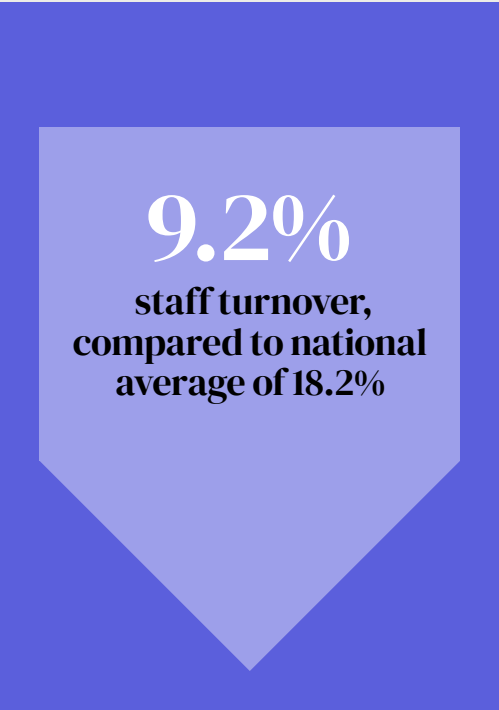
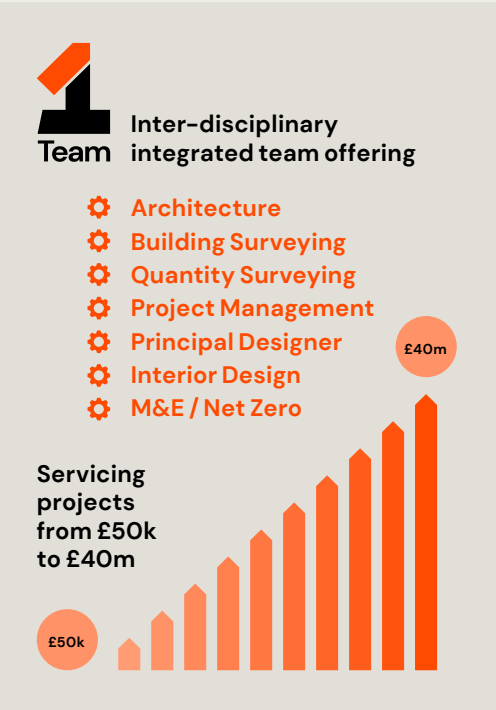



www.kendallkingscott.co.uk



Kendall Kingscott Ltd

